



**YANMAR** YMDM50 / YMGR88 / YMRB32 Hay Harvest System



**YMDM50 Drum Disc Mower  
YMGR88 Tedder Rake  
YMRB32 Round Baler**



The Yanmar Hay  
Harvest System

**CUT**  
YMDM50  
Disc Drum Mower

Now you can beat the high cost of hay from third-party growers with the Yanmar Hay Harvest System – reliable right-size solutions for horse and livestock owners.

Control your hay harvest and give your livestock the best. The Yanmar Hay Harvest System, made for subcompact and compact tractors, offers the best solution for your hay harvest needs. Cut fast and efficiently with the Model YMDM50 Disc Drum Mower. The Model YMGR88 Tedder Rake performs three functions: tedding, spreading and raking. Complete your hay harvest with the Model YMRB32 round baler and produce 28" W x 20" H twine-wrapped round bales weighing from 40–80 lbs. depending on crop type and conditions. All three require only a 3-point hitch & PTO connection (no hydraulics required).

**IMPROVE HAY QUALITY.**



# RAKE

YMGR88 Tedder Rake

# BALE

YMRB32 Round Baler

**YOUR LAND. YOUR TIME.**



YM50  
Drum Disc Mower



**TRIM YOUR TIME**



# A cut **above.**

## Yanmar Model YMDM50 Disc Drum Mower

allows for fast, efficient cutting of thick and lodged hay as field conditions allow, saving you time and money. The Yanmar drum disc mower contains two drum discs with three knives per drum, provides strong cutting power and easily maneuvers hay fields of almost any terrain. The discs have easily accessible grease and service points, allowing for quick, efficient maintenance.

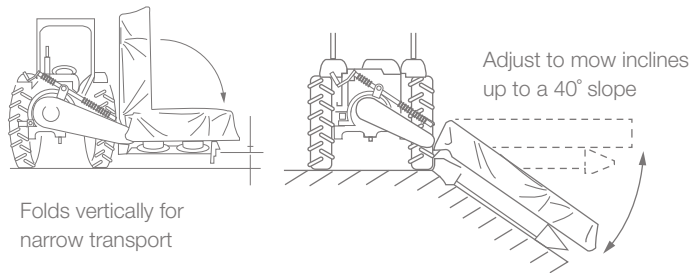

## Features

- Fast and efficient cutting gets you in and out of the field
- Dual drum discs with 3 knives per drum
- Utilizes a standard Category 1 three-point hitch and a 540 RPM PTO
- No tractor hydraulics required
- 51 inch cutting width
- Easily folds vertically for narrow transport
- Heavy-duty composite fabric cover
- No tools required for field adjustments
- Easily accessible grease and service points
- Release bar provides obstacle impact protection

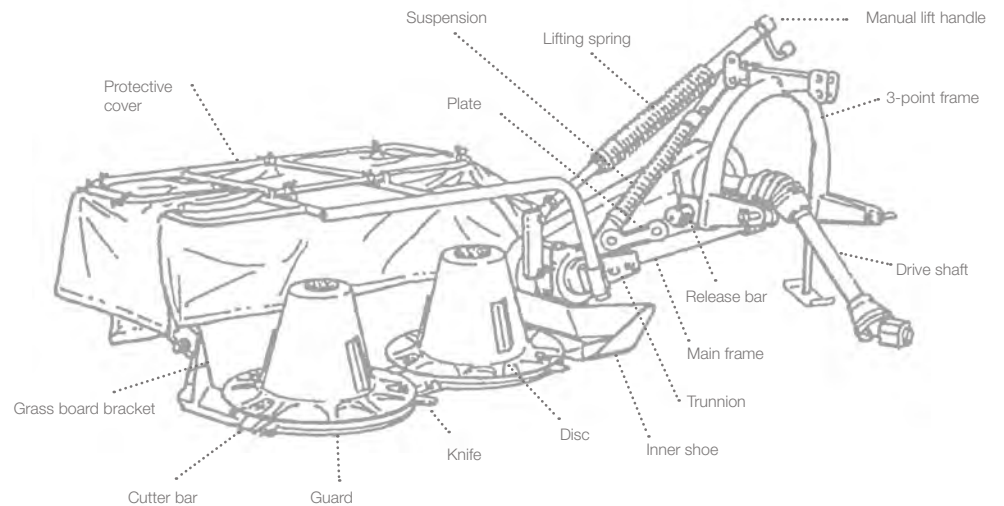

## Features

- Speeds drying to preserve hay quality
- Choose 3 functions with one attachment: ted, spread or windrow by shifting one lever
- 4 tine arms, 4 tines per arm
- Wide 86-inch raking width
- 3 point hitch mounted, PTO powered
- No tractor hydraulics required
- Precise, single pin height adjustment
- Easy to adjust windrow guard skirt for proper width for efficient baling
- No tools required to change functions
- Compact design allows harvesting in tight spots

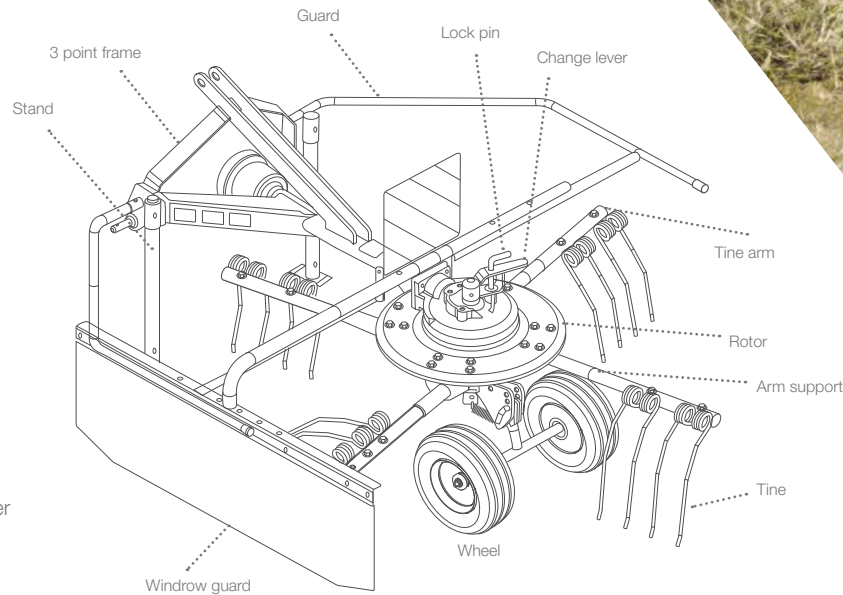

# Switch to **quality.**

## Yanmar Model YMGR88 3-in-1 Rotary Tedder Rake

Prepare your cut and dried hay for baling with the Yanmar Model YMGR88 rotary tedder rake. 3-point hitch mounted and PTO powered, this model gives you the flexible application, precision and maneuverability to harvest quality hay from tight places where every square foot of crop counts. The YMGR88 tedder/rake performs three functions—tedding, spreading and raking—and does not require any tools to switch among the three functions.

One adjustment changes function selection.

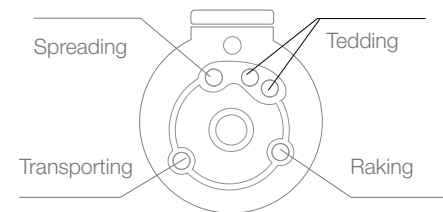



YMGR88  
3-in-1 Rotary  
Tedder Rake



**RAKE. SPREAD. TED.**



YMRB32  
Round Baler



**OPTIMUM NUTRITION**



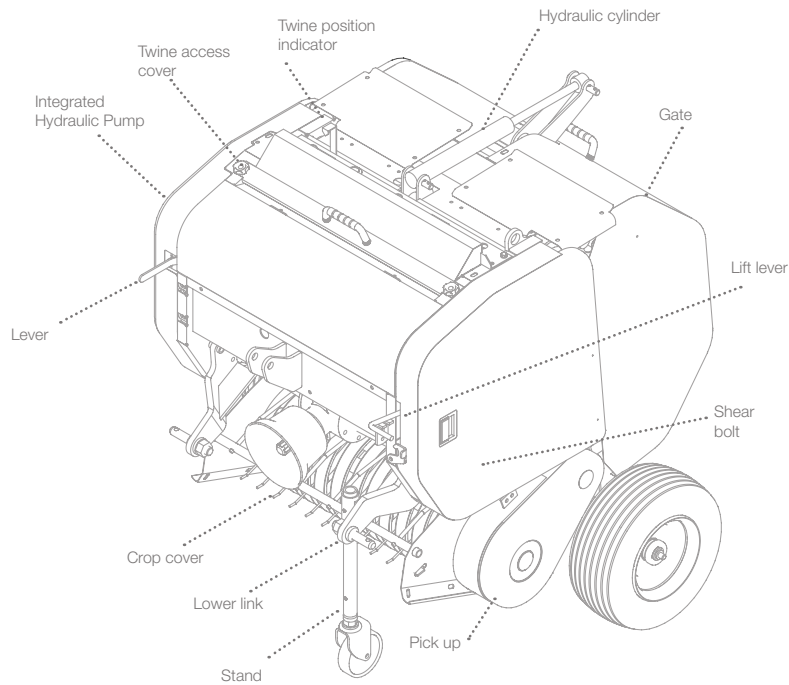

Remote control box

## Features

- Fixed chamber twine baler, chain and roller driven
- Ten durable steel rollers for crop compression
- 28" W x 20" H round bales, from 40-80 lbs. (18-36 kg) per bale depending on crop and conditions
- 31-inch wide pickup width
- Single adjustment sets bale density, (8 settings) higher to lower
- Utilizes a standard Category 1 three-point hitch and a 540 RPM PTO
- Shear pin PTO protection for overload
- Integrated Hydraulic Power Pack
- Remote control panel for easy control of bale gate open/close. Operated by self-contained hydraulics.
- Create 80-120 bales per hour
- Uniform bales stack easily for transport
- Ideal for hay and pine straw baling

# Control peak harvest time.

## Yanmar Model YMRB32 Subcompact Round Baler

A great small farm solution for owners of horses, cows, sheep, goats and other livestock. The YMRB32 subcompact baler produces 28" W X 20" H round bales weighing 40-80 lbs. each, easily managed by everyone that transports and handles the hay and cares for livestock. Its 3-point hitch and PTO powered connection delivers fast hay productivity and smooth operation to owners of compact and subcompact tractors. The baler features a remote-control panel for easy control of the power-lift bale gate to open and close. The baler's wide pickup design handles a wide range of crop conditions.



# EASY DOES IT.

Simple to operate. Simple to maintain. No tools required for field adjustments, just follow a few steps.



**Drum Disc Mower** – raise and lower by rotating the handle to change from transport position to working position.



**Tedder/Rake** Change functions by shifting one lever.

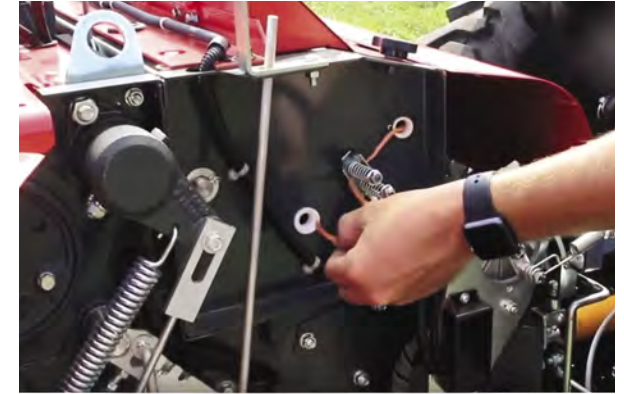

**Round Baler** Preparing the twine for harvesting.



**Raise and lower mower arm** with the 3-point hitch.



**Lubricate for long service** – Easily accessible grease and service points are quick and simple.

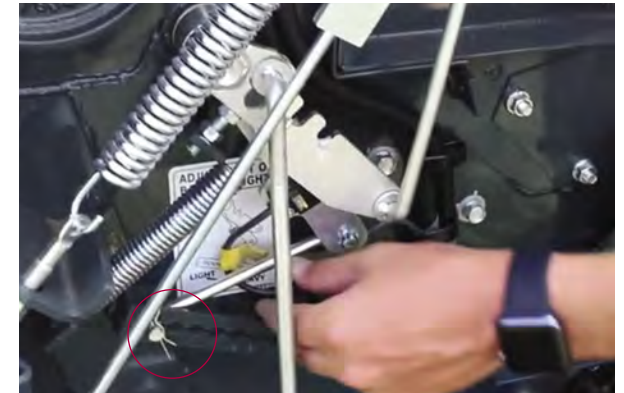

**Round Baler** – Adjust bale density easily by moving one pin to any of 8 positions.



# SPECIFICATIONS

## Yanmar YMDM50 Drum Disc Mower



MODEL	YMDM50
Tractor PTO HP	18 HP
PTO Speed	540 RPM
Hitch	Category 1
Number of Discs	2
Number of Knives	6
Cut Width in (m)	51 (1.3)
Width in (cm)	152 (258)
Height in (cm)	105 (140)
Length in (cm)	154
Weight lbs (kg)	476 (215.9)
Working Speed	6–12mph

## Yanmar YMGR88 Tedder Rake



MODEL	YMGR88
Tractor PTO HP	15 HP
PTO Speed	500–600 RPM
Hitch	Category 1
Raking Width in (m)	86 (2.2)
Transport Width in (m)	88 (2.2)
Tine arms	4
Tines per arm	4
Width in (cm)	152 (95)
Height in (cm)	105 (125)
Length in (cm)	195
Weight lbs (kg)	291 (131.9)
Working Speed	4–8mph

## Yanmar YMRB32 Round Baler



MODEL	YMRB32
Tractor PTO HP	18 HP
Hitch	Category 1
PTO Speed	540 RPM
PTO Protection	Shearbolt
# Steel Rollers	10
Bale Diameter in (cm)	20 (50.8)
Bale Width in (cm)	28 (71.1)
Inside Hay Pickup Width in (cm)	31 (78.7)
Bale Weight: lbs (kg)	40-80 (18-36)
Machine Width in (cm)	51 (129.5)
Height (gate closed) in (cm)	51 (129.5)
Length (gate closed) in (cm)	45 (114.3)
Weight lbs (kg)	734 (332.9)
Working speed	3–5mph



TO LEARN MORE ABOUT  
YANMAR HAY TOOLS  
PLEASE VISIT  
YANMARTRACTOR.COM

Yanmar Co., LTD.  
Head Office  
1-32, Chayamachi, Kita-ku, Osaka 530-0013, Japan

Yanmar America Corporation  
101 International Pkwy, Adairsville, GA 30103  
tel: 770.877.9894

[www.yanmartractor.com](http://www.yanmartractor.com)

The information in this brochure is accurate as of the date of printing and subject to change. All rights reserved by and belong to Yanmar®.  
©2018 Yanmar America Corporation. YT18-772-9/18

Yanmar has a corporate policy of continuous product improvement and development; therefore data, specifications, and warranty are subject to change without any advance notice. There may be differences between the specifications and illustrations contained in this publication and the actual equipment. Equipment components produced by other manufacturers may be shown in photographs in this publication for the purpose of illustration only and is not intended as an endorsement of that particular equipment or its suitability. Inspect equipment before using it and be sure it is operating properly. The product depictions are not meant to be used or relied upon as a substitute for the safety and use information that is published in the respective operator's manual. Before operating a machine, read, understand, and follow all instructions of the manual and on the machine. Yanmar disclaims all representations, express or implied, or any liability from the use of this publication.

